

# 2001 Beechhaven Circle ~ Lot 131

- 3 Car Garage
- 3,360 Square Feet
- 4 Bedrooms, 3.5 Bathrooms
- Master Suite w/ tray ceiling on main level / hardwood flooring, walk-in closet, master bath with his & her vanities, walk-in tiled shower & separate tub.
- Greatroom with hardwood flooring opens to breakfast room and kitchen.
- Spacious Kitchen with hardwood flooring, island, stainless appliances, granite counter tops, tiled backsplash,
- Bedroom #2 on main level.
- Bedroom #3 with private access to bath.
- Covered Back Porch

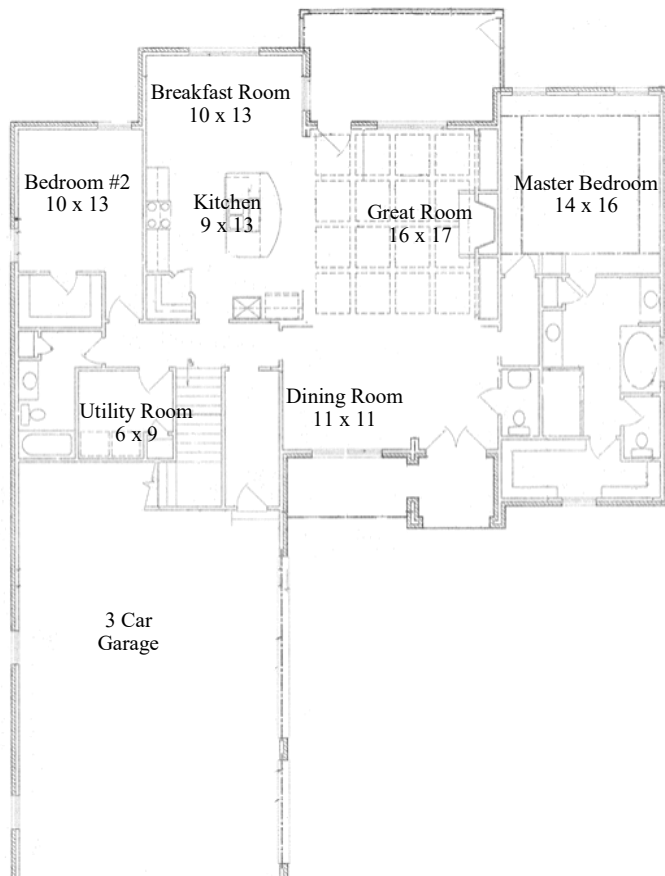

Illustrations of floorplan designs are artist renderings and are not intended to illustrate the finished product. Details will depend upon actual blueprint designs, builder specifications, and may vary depending on options selected.



\*Universal Builders LLC is also known as Kinsmen Ventures, LLC, TENN TX LLC, & Wright Farms, LLC



Listing Agent  
Margaret Dixon  
615-754-8999

**CRYE-LEIKE,**  
REALTORS®

All information deemed reliable, but not guaranteed and is Subject to change without notice



On-Site Agent  
Pam Bodiford  
615-812-9005